

---

**USER MANUAL**

**60" x 20" STEEL 750lb. HEAVY DUTY CARGO CARRIER**



**WARNING:**

Read carefully and understand all **ASSEMBLY AND OPERATION INSTRUCTIONS** before operating. Failure to follow the safety rules and other basic safety precautions may result in serious personal injury.

---

Please read and understand all instructions before use. Retain this manual for future reference.

## TECHNICAL SPECIFICATIONS

Item	Description
Product Size	60" x 20"x6"
Load Capacity	750 Lbs. cargo carrier
Hitch Size	2in. standard

## CARGO CARRIER USE AND CARE

- **Never exceed recommended load capacity of 750 lbs for cargo carrier**
- Do not modify the cargo carrier in any way. Unauthorized modification may impair the function and /or safety and could affect the life of the equipment. There are specific applications for which the cargo carrier was designed.
- Always check for damaged or worn parts before using the cargo carrier. Broken parts will affect the cargo carrier operation. Replace or repair damaged or worn parts immediately.
- Distribute the load evenly. Uneven loads may cause the cargo carrier to tip, resulting in damage to personal property or to the vehicle.
- Use the cargo carrier only with 2in. Class III and Class IV hitches. Always position loads evenly and secure with tie-down straps.
- Never block or impede vehicle exhaust. Loading items that block exhaust can cause fire or damage to personal property and vehicle.
- Stay alert, watch what you are doing and use common sense when using the cargo carrier. Secure all cargo with tie-down straps and /or bungee cords(not included).

### **When assembling, installing, or removing the cargo carrier**

- Keep work area clean, free of clutter and well lit. Cluttered and dark work areas can cause accidents.
- Keep children and bystanders away while assembling, installing or removing the cargo carrier. Distractions can cause lose of control, so visitors should remain at a safe distance from the work area.

## Assembly Instructions

1. Unpack all parts and identify according to the FIG. and parts list.
2. Install two M12 x75bolts (11) through frame (1), 2" tube body assembly (2), and frame (1). Install flat washers M12 (10), and lock nuts M12 (9) on the bolts.  
*REMARK: DON'T TIGHTEN THEM UNTIL THE CONNECTING PLATE (PART NO. 3) INSTALLATION IS FINISHED.*
3. Place the 2 pcs of connecting plates (3) onto frames.  
Install M10x20 bolts (14) through frames (1 ), flat washers M10 (13), and tighten them together with the M10 lock nuts (12).
4. Connect the 2" foldable tube (4) onto 2" tube body assembly (2) with the bolt M16 (8) and connecting pin (6)

## Fold up cargo carrier when Not In Use

1. Pull out the pin (5) and the connecting pin (6).
2. Turn the frame body up until the frame body is vertical.
3. Insert the connecting pin (6) through the 2" tube body assembly (2) and the lower hole of the 2" foldable tube (4) and insert the clip (5) into the connecting pin (6).

**FIGURE**

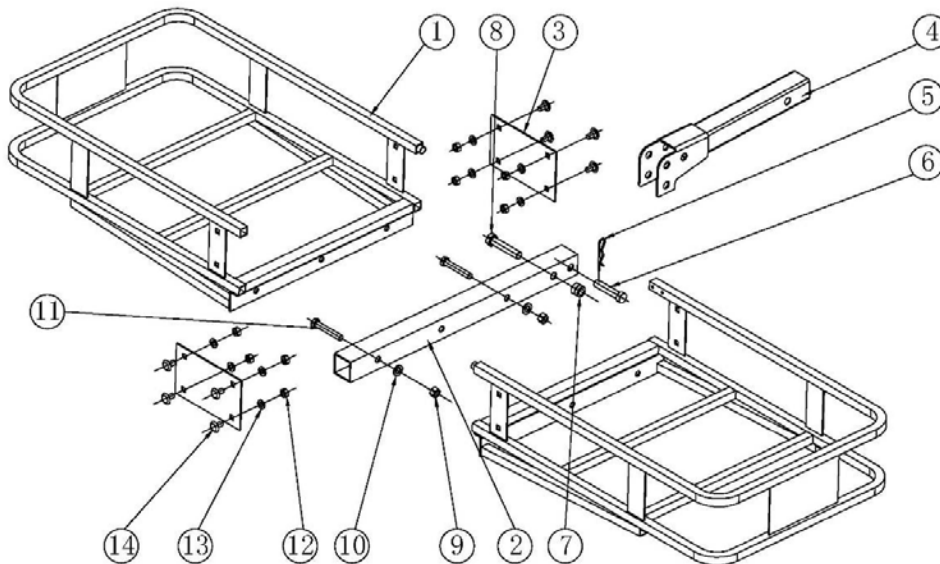

## PARTS LIST

ITEM	QUANTITY	DESCRIPTION
1	2	Frame(left & right)
2	1	2" Tube body assembly
3	2	Connecting plate
4	1	2"foldable tube
5	1	Clip
6	1	Connecting pin
7	1	M16 Lock nut
8	1	M16x80 Bolt
9	2	LOCK NUT M12
10	2	M12 Flat washer
11	2	M12x75 Bolt
12	8	M10 Lock nut
13	8	M10 Flat washer
14	8	M10x20 bolt